



SERVING THE FOOD INDUSTRY SINCE 1951

Refrigerated Pizza Prep Table

ITEM: 50042
MODEL: PT-CN-1270-HC

50043
PT-CN-1829-HC

50044
PT-CN-2337-HC



Designed for fresh ingredients, faster prep, and consistent results

This refrigerated prep table offers a spacious work area for storage and food preparation, with efficient R290 refrigeration for safe, eco-friendly cooling. Built from high-quality stainless steel with aluminum backing, it ensures durability, hygiene, and easy maintenance. Features include a 0.6-inch cutting board, self-closing doors with a 90° stay-open option, and adjustable heavy-duty shelves—making it a reliable, versatile solution for busy professional kitchens.

- Stainless steel exterior with aluminum back
- Maintains safe & reliable food temperatures
- Self-closing doors with 90° stay-open function
- Adjustable heavy-duty shelves
- 0.6" (15 mm) cutting board
- Eco-friendly R290 refrigerant

Telephone: 1-800-465-0234

Fax: (905) 607-0234

Email: sales@omcan.com

Website: www.omcan.com



Authorized Dealer



Made in China

(Version 2025.08)

Page 1 / 3

TECHNICAL SPECIFICATION

Features	50" wide/ 13.8 cu.ft / 391 L Capacity	71" wide/ 16.9 cu.ft/ 478 L Capacity	92" wide/ 24.2 cu.f.t / 684 L Capacity
Item	50042	50043	50044
Model	PT-CN-1270-HC	PT-CN-1829-HC	PT-CN-2337-HC
Capacity	13.8 cu.ft / 391 L	16.9 cu.ft / 478 L	24.2 cu.ft / 684 L
Number of Doors	1 Door	2 Doors	3 Doors
Number of Pans	6 x 1/3 pans	9 x 1/3 pans	12 x 1/3 pans
Number of Shelves	1 Shelf	2 Shelves	3 Shelves
Shelf Material	Plastic Coated		
Shelf Capacity	73 lbs/ 33 kgs	64 lbs / 29 kgs	61.7 lbs / 28 kgs
Number of Casters	4	4	6
Power	1/6 HP	1/5 HP	1/4 HP
Current	2.64 A	3.42 A	5.28 A
Electrical	110V / 60 Hz / 1 Ph		
Temperature Controller	Digital		
Temperature Range	0.5°C - 4.4°C (33°F - 40°F)		
Refrigerant	R290		
Insulation Material	Cyclopentane		
Cooling System	Ventilated		
Defrosting	Automatic		
Interior Dimensions (WDH)	27.4" x 22.8" x 26.2" / 696 x 580 x 665 mm	48.4" x 22.8" x 26.2" / 1229 x 579 x 665 mm	69.45" x 22.83" x 26.18" / 1764 x 579 x 664 mm
Net Weight	374 lbs/ 170 kgs	431 lbs/ 196 kgs	565 lbs/ 257 kgs
Net Dimensions (WDH)	49.9" x 31.5" x 42.9" / 1266 x 800 x 1088 mm	70.9" x 31.5" x 42.9" / 1800 x 800 x 1088 mm	91.9" x 31.5" x 42.9" / 2334 x 800 x 1088 mm
Gross Weight	497 lbs/ 226 kgs	563 lbs/ 256 kgs	719 lbs/ 327 kgs
Gross Dimensions (WDH)	54" x 37" x 46" / 1380 x 920 x 1160 mm	76" x 37" x 46" / 1920 x 920 x 1160 mm	97" x 37" x 46" / 2450 x 920 x 1160 mm
Plug Type	NEMA 5 - 15 P		

TECHNICAL DRAWING

Item: 50042

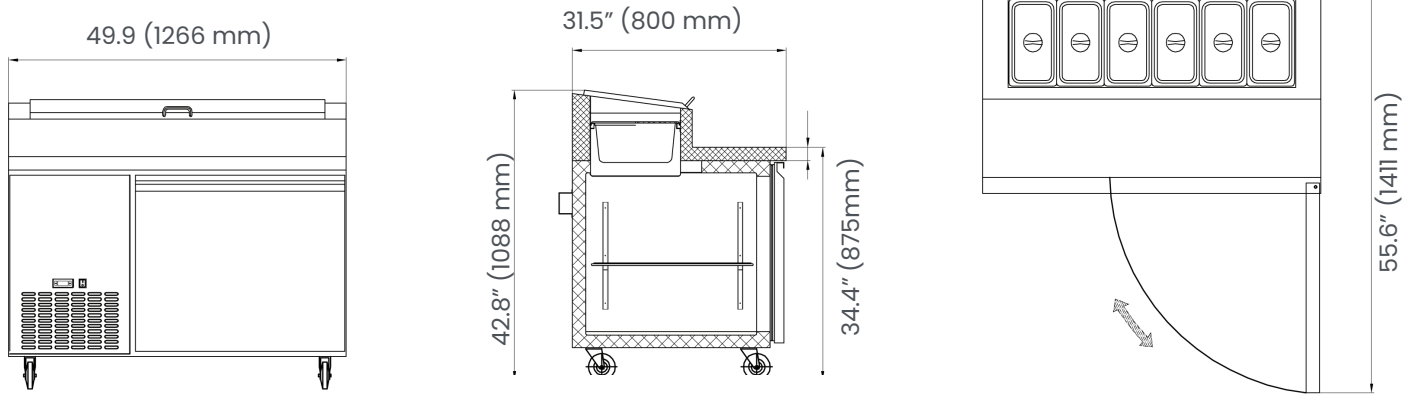

Item: 50043

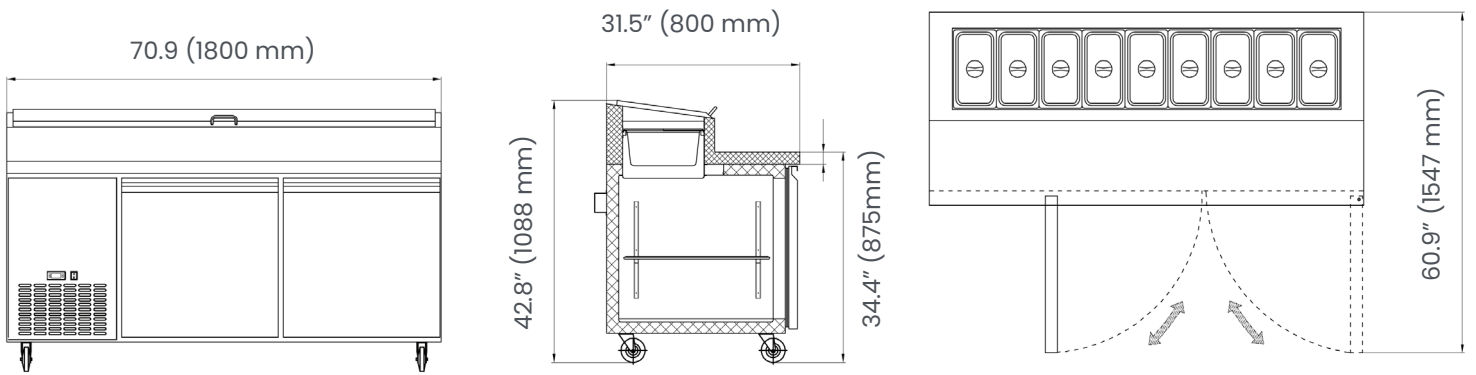

Item: 50044

